

THIS COPY IS PROVIDED ON A RESTRICTED BASIS AND IS NOT TO BE USED IN ANY WAY DETRIMENTAL TO THE INTERESTS OF PANDUIT CORP.

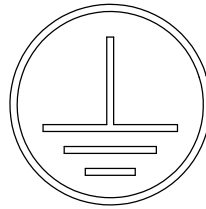

CLEANING PAD (QTY. 1)



UNIVERSAL GROUNDING STICKER (QTY. 2)



5cc TUBE ANTI-OXIDANT PASTE (QTY. 1)

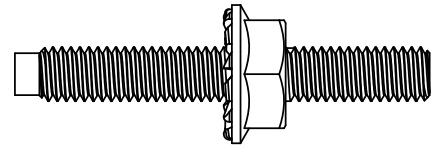

#12-24 & M6 BONDING STUD (QTY. 8 OF EACH)

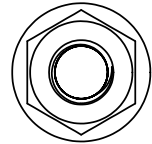

#12-24 & M6 BONDING NUT (QTY. 16 OF EACH)

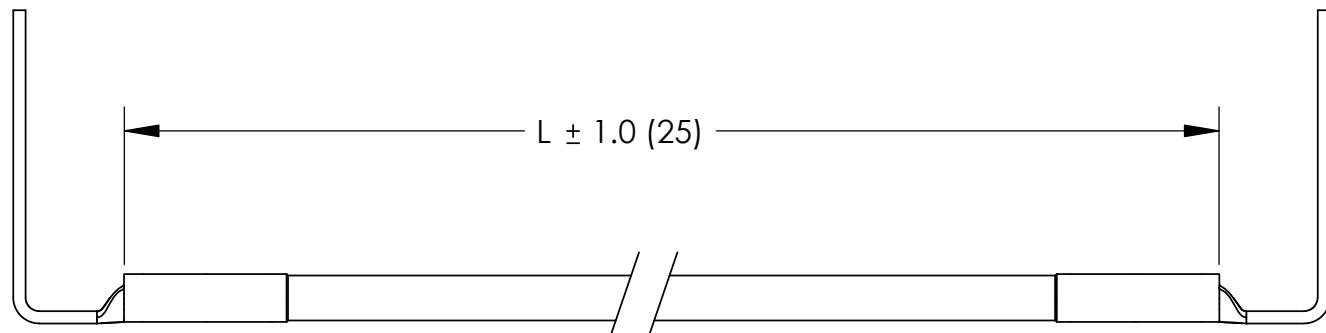

FACTORY CRIMPED #6 AWG FRONT TO BACK RAIL JUMPER GREEN/YELLOW INSULATION (QTY. 2)

PART NUMBER	L
CGJ620U	20.00 (508)
CGJ630U	30.00 (762)
CGJ640U	40.00 (1016)

NOTES:

- CABINET GROUNDING JUMPER KIT
PART NUMBERS: CGJ620U, CGJ630U, CGJ640U
- PACKAGING: 1 KIT PER BAG
- DIMENSIONS IN PARENTHESIS ARE MILLIMETERS.
- ALL COMPONENTS THAT MAKE UP THIS KIT ARE RoHS COMPLIANT.



LISTED
GROUNDING AND BONDING EQUIPMENT

CERTIFIED

C41626_01

PANDUIT CORP. TINLEY PARK, ILLINOIS

FRONT TO BACK RAIL JUMPER KITS
(CGJ620U, CGJ630U, CGJ640U)
CUSTOMER DRAWING

UNLESS OTHERWISE SPECIFIED
DIMENSIONAL TOLERANCES ARE:
(.X) ± (.XXX) ±
(.XX) ± ANGLES ±

UNLESS OTHERWISE SPECIFIED,
ALL DIMENSIONS ARE GIVEN IN
INCHES, THIRD ANGLE PROJECTION

REV	DATE	BY	CHK	DESCRIPTION	ECN	PM	CUST	CHK'D	DRAWN BY	DATE	MAT'L:	SCALE	DRAWING NO / CAD FILE	DWG SIZE
01	3/06	JHNU	JHNU	REVISED DRAWING TITLE	PC00329				JHNU			NONE		
00	1/06	JHNU	JMAR	DRAWING RELEASED	PC00276					1/06			C41626	B SIZE